

FOR IMMEDIATE RELEASE

## Rollomatic spotlights fully interpolated 6-axis tool grinder with new options for grinding of solid carbide boring bars

Mundelein, August 2020. Rollomatic, a leading machine tool manufacturer based in Le Landeron, Switzerland, maintains its global leadership position by highlighting the new GrindSmart® model 630XW machine with new and innovative capabilities relating to the production grinding of solid carbide boring bars and other stationary cutting tools. Boring bar grinding on the Rollomatic 6-axis tool grinding machines offers exceptional flexibility in comparison to conventional single-purpose grinders. With its 6 fully interpolating CNC axes and a 6-station wheel/nozzle changer, the machine can easily be adapted for individual boring bar designs, both for short and long runs. The compact and versatile design allows full interchangeability between boring bars, inserts and round tools.



Full radius boring bar

Standard boring bar



GrindSmart®630XW 6-axis grinder with automatic loader and 6-station wheel/nozzle changer



GrindSmart®630XW3 6-axis grinder with automatic loader and 16-station wheel/nozzle changer

The following operations can be performed on the GrindSmart® series in one operation including flipping the tool:

- Profile grinding
- Grinding of rake face
- Grinding of coolant flat
- Grinding of neck
- Other brand-dependent features

While the machine is able to grind any large-size boring bar, its capabilities extend to miniature turning tools, boring, threading, grooving and facing tools. Both right hand/left hand and ahead/behind center can be produced with equal ease. Rake angles can be ground in 2 planes. Additionally, quick-change features can also be added to the grinding operations.

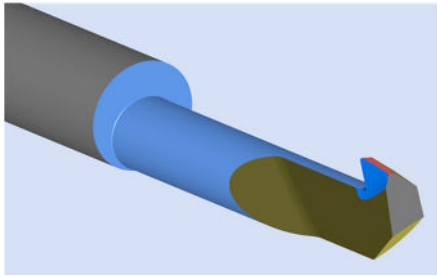

Reverse boring bar

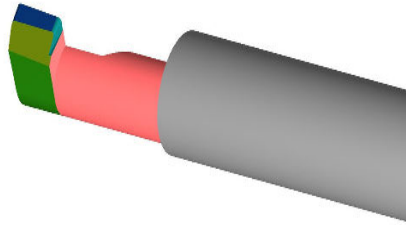

Retaining ring tool

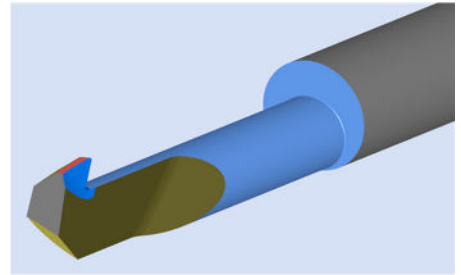

Reverse boring bar

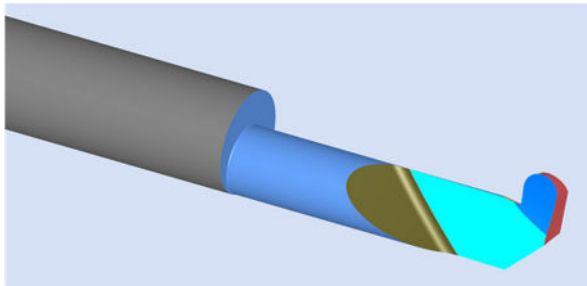

Full radius boring bar

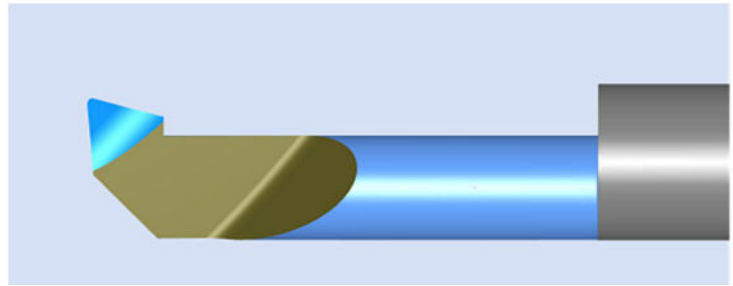

Standard boring bar with corner radius

Compared to dedicated insert grinders, the GrindSmart 6-axis series together with the wheel/nozzle changer offer the highest available flexibility for grinding a variety of boring bars and other stationary cutting tools, while maintaining the ability to switch over to round-shank tools within minutes.

- Radius contour accuracy due to mechanical and software features, as low as .0001" (2 microns).
- Pick-and-place robot, so that the tools do not get damaged after grinding.
- Wheel and nozzle changers with 6 positions or 16 positions. Each wheel pack can accommodate up to 4 wheels.
- In-process rotary dressing, or automatic sticking device available.
- Linear motion control on CNC axes.
- Desktop tool design software with 3D tool simulation and 3D machine animation with collision warning. High level of functionality, speed, freedom in tool design and user-friendliness.

Rollomatic provides outstanding service/support from its North American headquarters in Mundelein, IL, and satellite offices in CA, FL, IN, MA. For more information visit: [www.RollomaticUSA.com](http://www.RollomaticUSA.com) or e-mail [solutions@rollomaticusa.com](mailto:solutions@rollomaticusa.com).



North American Headquarters:  
Rollomatic Inc.  
1295 Armour Boulevard  
Mundelein, IL 60060  
Phone: 847 281 8550  
E-mail: [solutions@rollomaticusa.com](mailto:solutions@rollomaticusa.com)